

Packaged Units



sera - Packaged Units

allow a trouble-free and environment-friendly handling of liquid chemicals.



Application

Exact dosing of the liquids is guaranteed by the precisely working **sera**-units.

Advantages

- Compact design
- High reliability
- Simple operation
- Universal applicability

Ask us to submit a quotation to meet your specific requirements!



Dimensions of tank with pump on top:

Tank capacity [l]	Tank dimensions diameter ø D [mm]	height H [mm]	Total height L [mm]	Pump type
35	320	470	approx. 700	R 202 / C 202 / R 302 / R 408.1 / C 408.1
75	460	600	approx. 950	R 202 / C 202 / R 302 / R 408.1 / C 408.1 / R 409.1
100	460	750	approx. 1150	R 202 / C 202 / R 302 / R 408.1 / C 408.1 / R 409.1 / C 409.1
200	600	880	approx. 1350	R 202 / C 202 / R 302 / R 408.1 / C 408.1 / R 409.1 / C 409.1
300	670	1030	approx. 1500	R 202 / C 202 / R 302 / R 408.1 / C 408.1 / R 409.1 / C 409.1
500	790	1180	approx. 1700	R 202 / C 202 / R 302 / R 408.1 / C 408.1 / R 409.1 / C 409.1 / R 412 Soe
1000	1080	1260	approx. 1750	R 202 / C 202 / R 302 / R 408.1 / C 408.1 / R 409.1 / C 409.1 / R 412 Soe

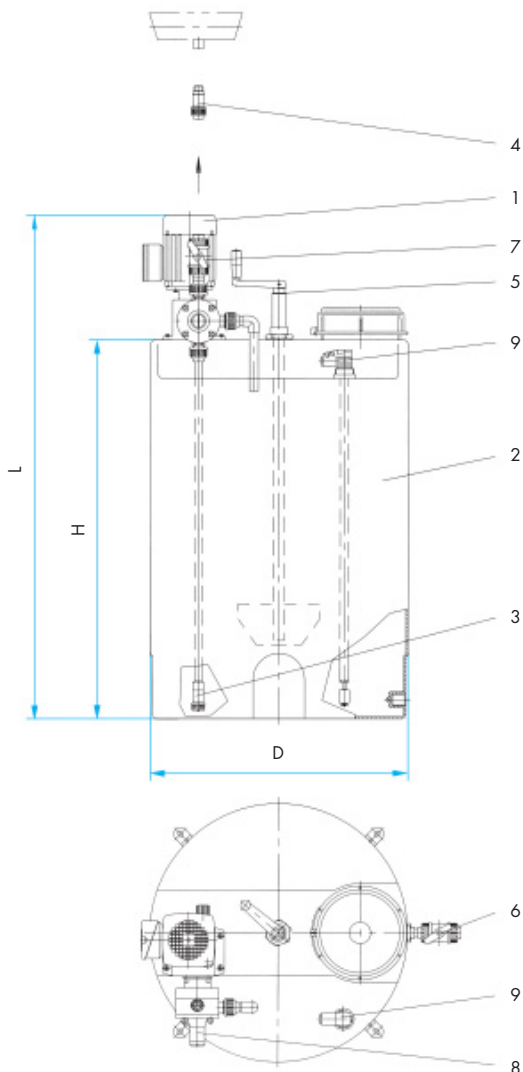

Possible components:

- Diaphragm dosing pump;** please refer to the schedule on the front page to find out the suitable type. For higher pressures also piston and piston diaphragm pumps can be employed. The technical data of these pumps are included in the respective data sheets.
- Dosing tank** made of transparent polyethylene, resistant to shock, UV-stabilised, complete with litre scale and chemical inlet with screw cap (lockable as an option).
- Suction line** with foot valve
- Injection fitting** for vertical installation
- Manual or electric agitator** (for tanks with a contents of more than 500 l only electric agitator, see picture on front page)
- Drain valve**
- Shut-off valve** to be mounted onto pressure joint. If this is fitted a relief valve must be installed to protect the pump against overpressure.
- Relief valve** – including return pipe (separately or integrated on pump head).
- Solenoid float switch**

Tanks with larger capacities and special accessories can be supplied on request!

CE

sera
Dosing
Feeding
Compressing



Seybert & Rahier GmbH + Co. Betriebs-KG

sera-Straße 1 · D-34376 Immenhausen
Phone + 49 56 73 99 90
Fax + 49 56 73 99 91 55
e-mail: info@sera-web.de
Internet: www.sera-web.de